



INSTALLATION INSTRUCTIONS

Accessory

WINDSCREEN
P/N 08R80-MCZ-100

Application

CB900F

Publications No.

M11 9619 (0203)

Issue Date

May 2002

Honda Dealer: Please give a copy of these instructions to your customer.

PARTS LIST

No.	Description	Qty
(1)	Windscreen	1
(2)	Right stay	1
(3)	Left stay	1
(4)	Collar (long)	2
(5)	Collar (short)	2
(6)	6 mm flange bolt	2
(7)	6 mm stepped screw	4
(8)	8 mm flange bolt	2
(9)	Rubber	4
(10)	Nylon washer	4
(11)	6 mm cap nut	4
(12)	Grommet	2

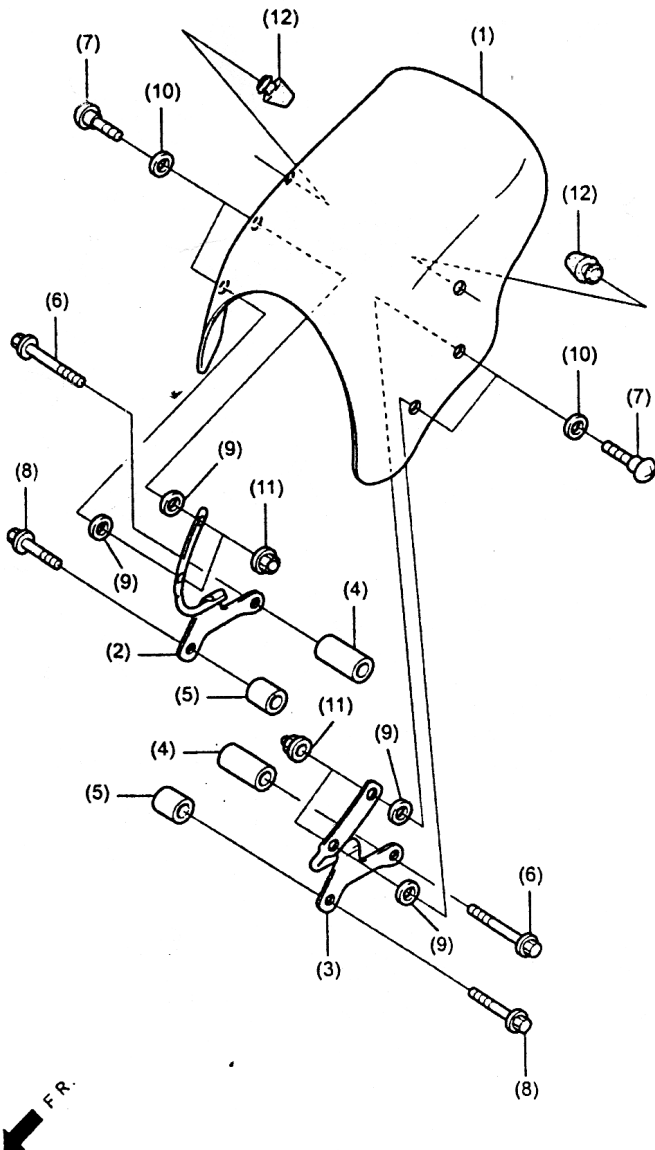

TOOLS AND SUPPLIES REQUIRED

- Socket (10 and 13 mm)
- Ratchet
- Box-end wrench (10 mm)
- Hex socket (5 and 8 mm)
- Phillips ® screwdriver
- Torque wrench

TORQUE CHART

Tighten all screws, bolts, and nuts to their specified torques.

Item	N·m	kgf·m	lbf·ft
6 mm stepped screw	9	0.9	6.5
6 mm flange bolt and nut	12	1.2	9
8 mm flange bolt	26	2.7	20

USE AND CARE INFORMATION

- When the windscreen becomes dirty, rinse it thoroughly with cool water to remove loose dirt, then wipe with a clean cloth or sponge.
- Never use organic solvents such as gasoline, thinner or benzene to clean the windscreen. Also do not use acid or alkaline cleaners to clean this accessory.
- If the motorcycle is left covered for an extended period of time, park in the shade. Parking a covered motorcycle in direct sunlight can cause the windscreen to deform due to heat buildup under the cover.
- Check the windscreen mounts frequently and retighten if necessary.

INSTALLATION

1. Remove the motorcycle's headlight unit.

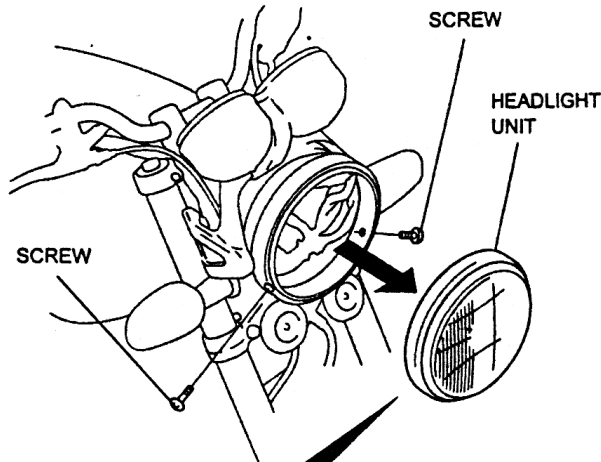

Do not tamper with the headlight beam adjusting screw.

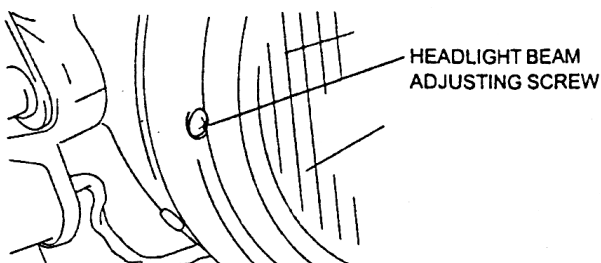

2. Using a shop towel to rest the windscreen on, assemble the following parts as shown. Tighten the 6 mm stepped screws to the specified torque.

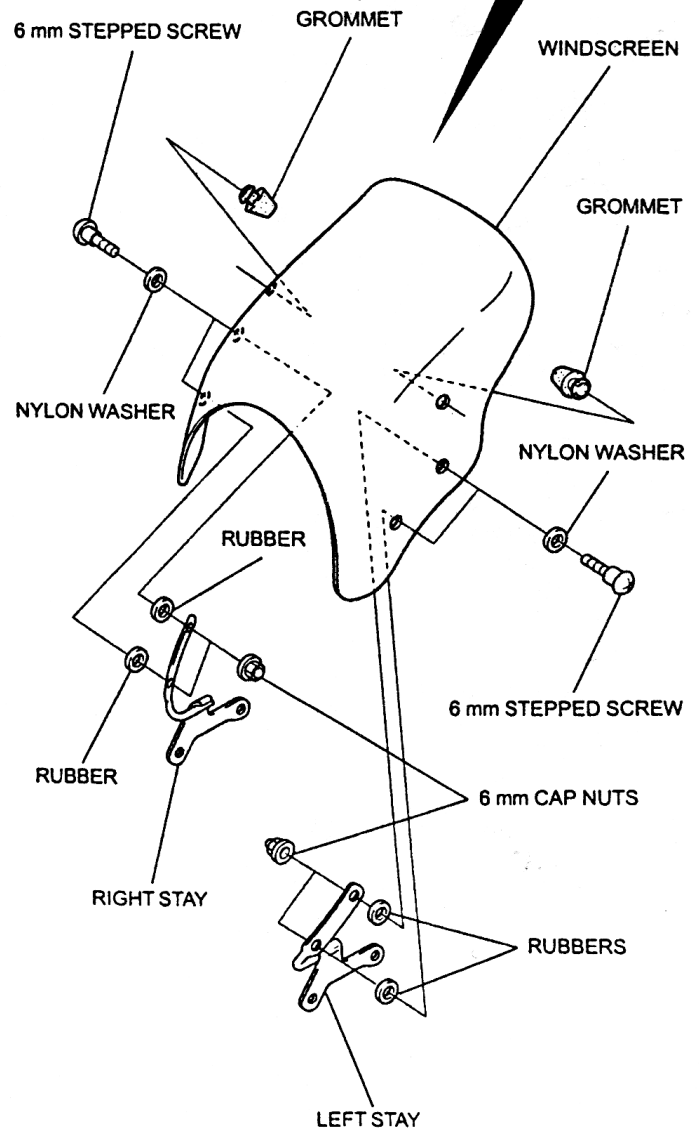
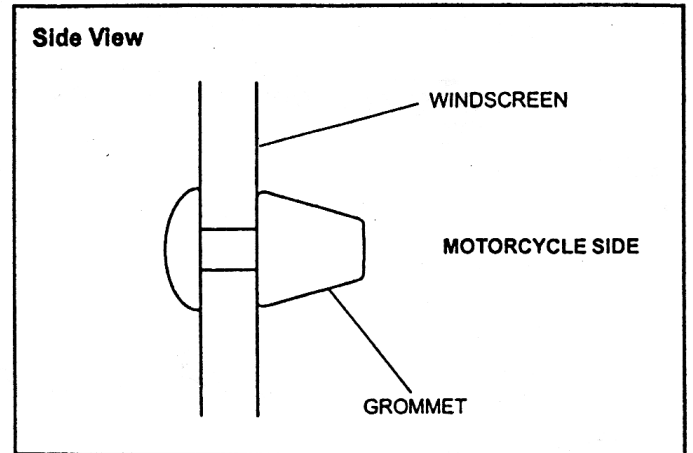

3. Using two people, loosely tighten the windscreen sub-assembly on the motorcycle.

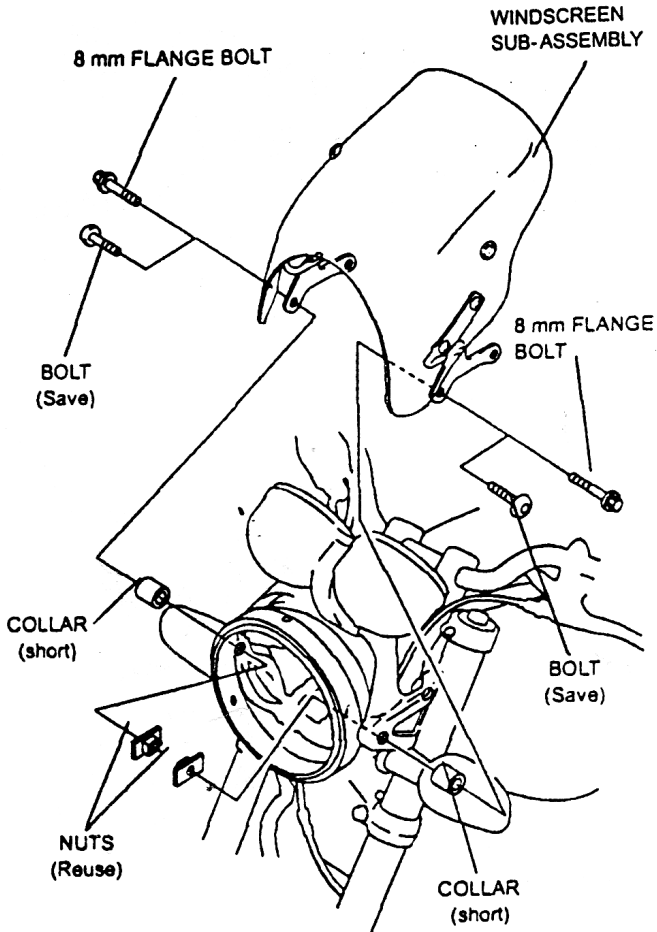

4. Install the motorcycle's headlight unit as shown.

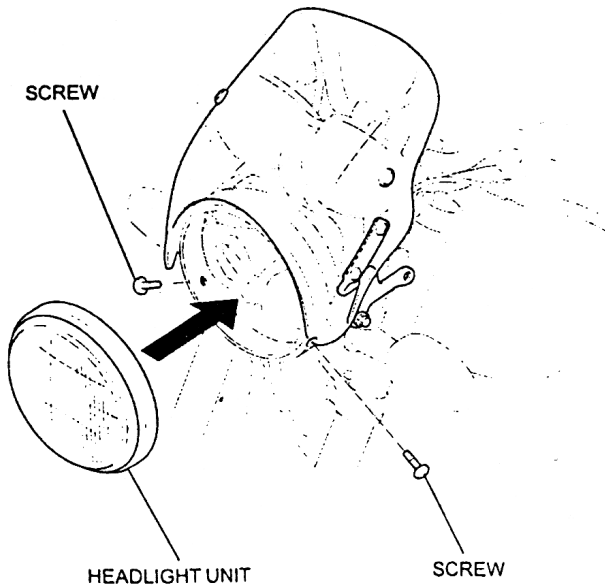

5. Remove the corresponding unit-side bolts and attach the right and left stays with a 6 mm flange bolt and long collar as shown.

Align the mark on the headlight case with the alignment mark on the motorcycle. Tighten the 6 and 8 mm windscreen stay bolts to the specified torque.

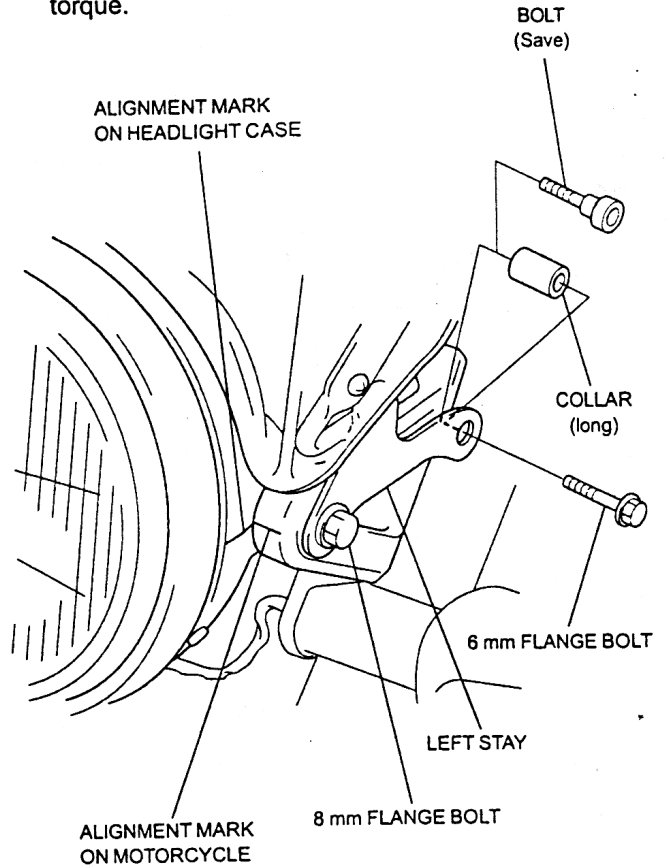

CHECK AFTER INSTALLATION

Check the headlight for proper operation and beam adjustment.