



# TECHNICAL SERVICE BULLETIN

Release Date: June 20, 2017

Expiration Date: NA

## Victory Motorcycle

Bulletin Number: V-17-02

Model Years: 2010-17

☐ Safety Bulletin

☒ **Service Bulletin**

☐ Service Alert Fax

Distribution: ☐ Owner / Principal ☐ Service Manager ☐ Sales Manager ☐ Parts Manager ☐ Technicians

*This Service Bulletin is located at [www.polarisdealers.com](http://www.polarisdealers.com)*

-Confidential and Proprietary-

**VERSION: R01 (June 20, 2017)**

### IMPORTANT

If you are working with a printed copy, please verify you have the most current version of these instructions.

**SUBJECT: 2010-17 Victory Cross Country / Cross Country Tour / Cross Roads /  
Magnum / Hard Ball brake line routing**

#### PURPOSE:

Victory engineering has determined that some Cross Country, Cross Country Tour, Cross Roads, Magnum and Hard Ball models may experience damage to the rear brake line. Motorcycles experiencing prolonged misfire conditions may produce increased catalytic converter temperatures causing the retention clip securing the rear brake line to melt. In extreme cases, the retention clip may melt onto the catalytic converter, and increasing the risk of brake line damage.

Victory is directing dealers to remove the panduit strap and clip from the left-hand passenger footrest support, and reassemble with improved line routing and a newly designed swingarm guard.

#### AFFECTED MODELS:

MODEL YEAR	MODELS	VEHICLE IDENTIFICATION NUMBER RANGE
2010	Cross Country / Cross Country Tour / Cross Roads / Magnum / Hard Ball	Reference "Unit Inquiry" on the dealer website or the Service Bulletin list on the STOP site to lookup affected units.
2011		
2012		
2013		
2014		
2015		
2016		
2017		

#### CUSTOMER NOTIFICATION:

Dealers are required to review their sales records and make arrangements with customers as needed. In addition to consumer units, dealers are required to correct any affected units in their inventory.

## WARRANTY CLAIM:

Bulletin parts are excluded from the standard RMA policy and cannot be returned. To assure we can update as many units as soon as possible, please only place orders to update units in current inventory and customer units.

<b>SERVICE BULLETIN #</b>	V-17-02
<b>CLAIM TYPE</b>	SB (Service Bulletin)
<b>LABOR ALLOWANCE</b>	18 Minutes (0.3 Hours)
<b>PART NUMBER / DESCRIPTION</b>	2207333 (QTY.1) KIT, SWINGARM GUARD 7170107 (QTY.1) BULLETIN COMPLETION DECAL
<b>PARTS AVAILABILITY</b>	Available to Order
<b>UNIVERSITY OF POLARIS VIDEO TRAINING REQUIREMENT</b>	NO

## INSPECTION REPAIRS:

If during the inspection procedure "Passenger Footpeg Removal" of this bulletin, damage to any of the peripheral components listed below is discovered, start an ASK Polaris case and submit photos of the damage.

### ABS BRAKE LINE REPLACEMENT

PART DESCRIPTION	P/N	QTY.
ABS BRAKE LINE	1911697	1
WASHER, COPPER, SEALING	7556372	4
BRAKE FLUID, PINT	2872189	1
LABOR		2.0 HR

### NON-ABS BRAKE LINE REPLACEMENT

PART DESCRIPTION	P/N	QTY.
NON-ABS BRAKE LINE	1911574	1
WASHER, COPPER, SEALING	7556372	4
BRAKE FLUID, PINT	2872189	1
LABOR		1.5 HR

### OIL PRESSURE SWITCH HARNESS REPAIR

PART DESCRIPTION	P/N	QTY.
OIL PRESSURE SWITCH REPAIR KIT	2207334	1
LABOR		0.3 HR

### SIDESTAND SWITCH REPLACEMENT

PART DESCRIPTION	P/N	QTY.
SIDESTAND SWITCH	4013130	1
LABOR		0.3 HR

## ACCESSORY REMOVE & REPLACE LABOR:

Polaris will cover labor for the removal and installation of accessories required to complete the bulletin work. Follow the steps below to obtain reimbursement.

For accessory removal and installation up to 1 hour of labor:

1. Start a new warranty claim under the Service and Warranty dropdown and enter the VIN.
2. Enter the Date Failed and Date Repaired information into the applicable fields.
3. Enter "V-17-02" in the Authorization field.
4. Enter the miles and hours.
5. Enter the labor time up to 1 hour.
6. Enter "V-17-02" in the CONCERN and CAUSE fields. In the CORRECTION field, enter "ACCESSORY REMOVAL AND INSTALLATION".
7. Add part 0000541, quantity 1.
8. Enter warranty fail codes 113/259/114.
9. Validate the parts.
10. Save and submit the claim to Polaris.

For accessory removal and installation over 1 hour of labor:

1. Start a new Ask Polaris Case, Service & Warranty Question > Authorization: Non-Cosmetic & Polaris ESC or Authorization: Out of Warranty.
2. Enter your contact information and VIN, along with miles and hours into the applicable fields.
3. Enter "V-17-02" in the CONCERN and CAUSE fields. In the CORRECTION field, enter "ACCESSORY REMOVAL AND INSTALLATION".
4. Enter warranty fail codes 113/259/114.
5. Add part 0000541, quantity 1.
6. Attach photos of the vehicle and accessories sufficient to support the labor time requested.
7. Submit the case to Polaris.

### NOTE

Polaris requires dealers to maintain warranty records, including repair orders and supporting documentation for five years. All claims for additional labor for V-17-02 are subject to audit and inspection. Infractions will result in chargebacks and fines in accordance with the Polaris Audit Policy.

## WARRANTY COVERAGE PERIOD:

Warranty coverage for Service Bulletin V-17-02 will begin June 20, 2017. This bulletin has no expiration date.

## DISPOSAL INFORMATION:

Under no circumstances shall the parts removed in this repair be re-used, sold, or re-purposed for another application. It is your dealership / distributor's responsibility to make sure every part replaced (related to this bulletin) is taken out of circulation and disposed of properly.

## SERVICE BULLETIN COMPLETION DECAL:

A Service Bulletin Completion Decal must be completed for this bulletin repair. Remove the inside left cover and place the decal on inside of the cover. If you require more decals, order them through normal Polaris parts ordering channels.

## FEEDBACK FORM:

A feedback form has been created for the technician to provide POLARIS with an overall satisfaction rating for the instructions, provide comments on your experience or upload pictures/videos from a specific repair. This feedback form is viewable on a mobile device by scanning the QR code shown or by clicking [HERE](#) if viewing this document electronically.

### FEEDBACK FORM



**KIT CONTENTS (P/N 2207333):**

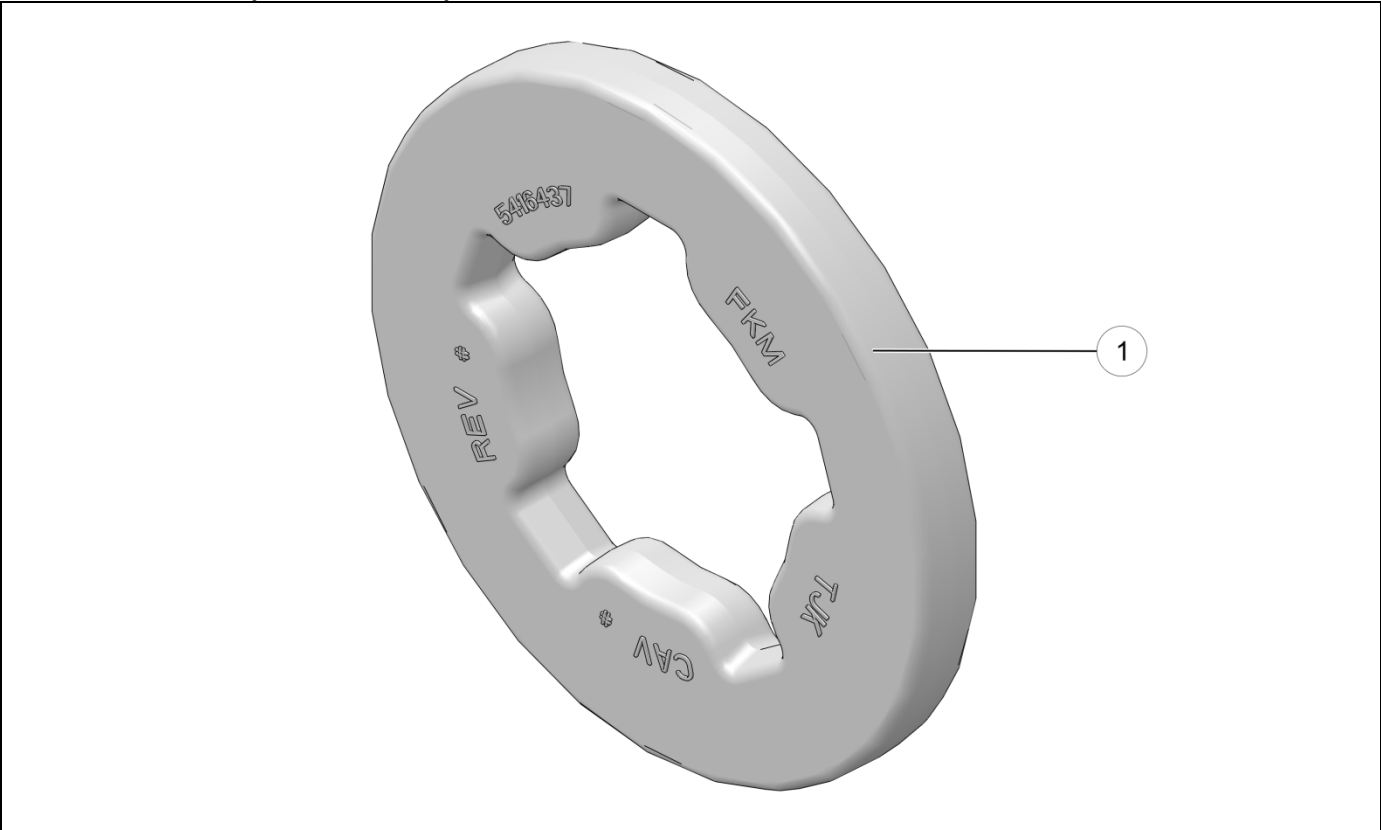

REF	PART DESCRIPTION	PART NUMBER	QTY
①	Swingarm Guard	5416437	1
	Rear Brake P-Clamp (non-abs only)	7080983	2
	V-17-02 Swingarm Guard Kit Reminder Instructions	9928447	1

## **SWINGARM GUARD INSTALLATION:**

### Tools Required:

- ½" Breaker Bar
- Side Cutter
- Torque Wrench
- 6 mm allen socket
- 24 mm socket
- Paint Pen

### **WARNING**

Allow the vehicle to adequately cool before beginning this procedure. Servicing Engine and Exhaust system components before they cool may lead to severe burns.

## **PASSENGER FOOTPEG REMOVAL**

1. Park motorcycle on a lift table with the front wheel clamped in a wheel vise, turn ignition OFF.
2. On the left-hand side of the motorcycle, remove side cover.

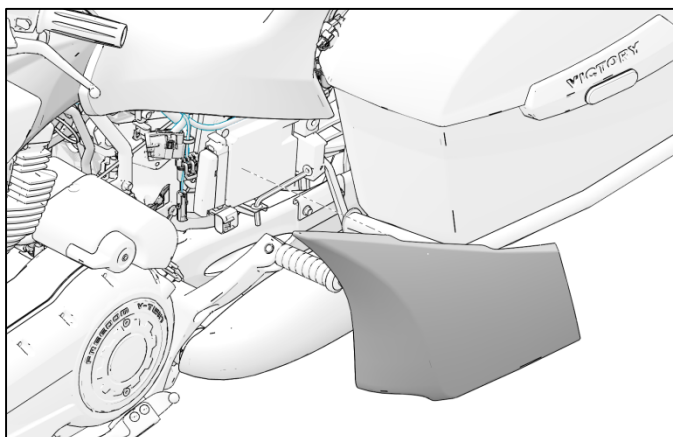

3. Using a 6 mm allen wrench, remove lower passenger footrest bolt ①.

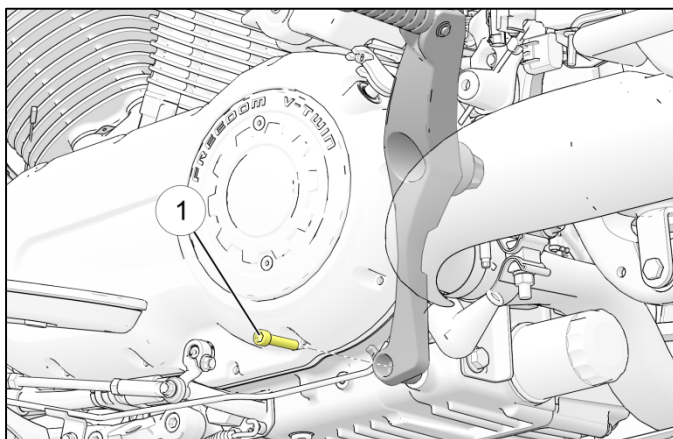

4. Using a 24 mm socket and a ½" drive breaker bar, remove upper passenger footrest nut ② and washer.

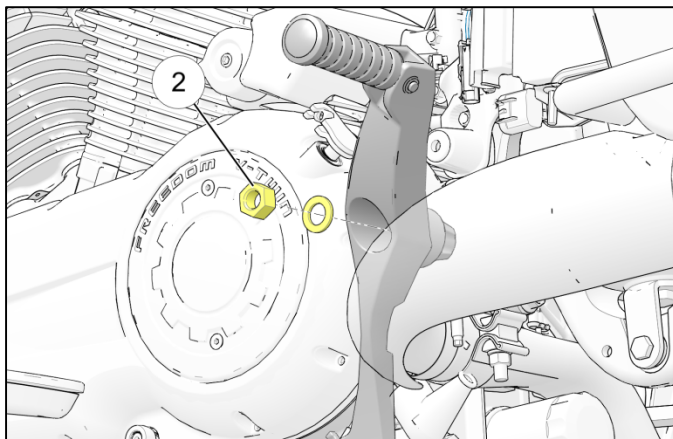

5. Disconnect oil pressure switch connector ③.

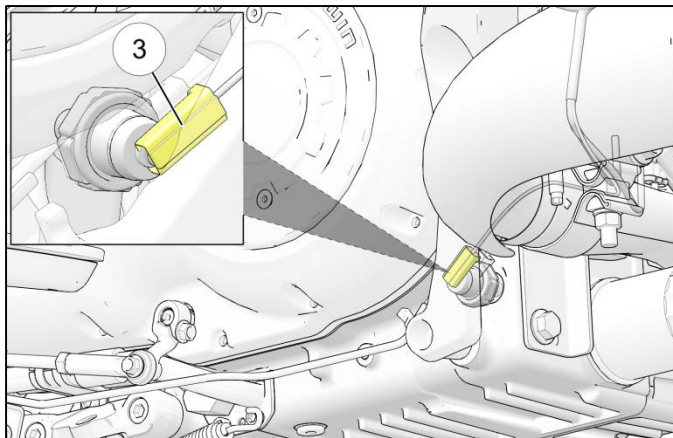

6. Pull footrest bracket away from swingarm far enough to expose the Panduit strap ④; retaining the brake line and electrical harness. Clip the Panduit strap ④ with a side-cutter.

**CRITICAL**

Do not to cut the electrical harness or brake line when cutting Panduit strap.

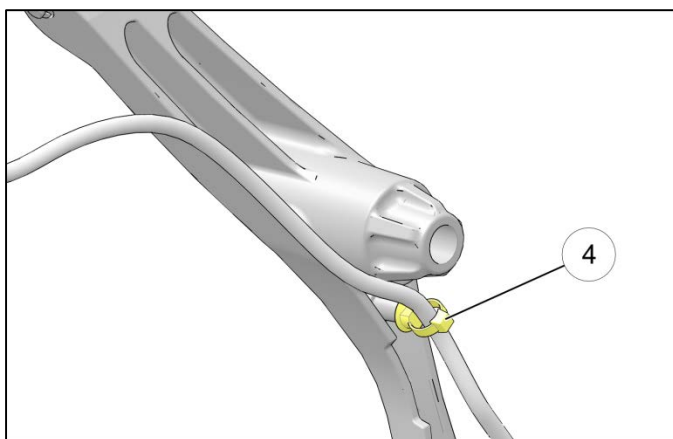

7. Turn the remaining portion of the retaining clip counter-clockwise to remove from the footrest bracket.

**IMPORTANT**

Verify that no residual material is left behind after retaining clip is removed.

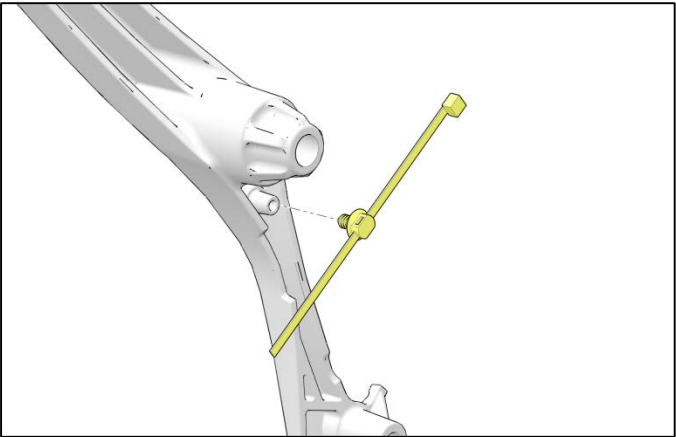

**CRITICAL**

Measure 6 inches rearward from the Brake Line crimp location. Inspect brake line, oil pressure switch and sidestand switch wire (INTL models) for thermal damage.

Replace if necessary.

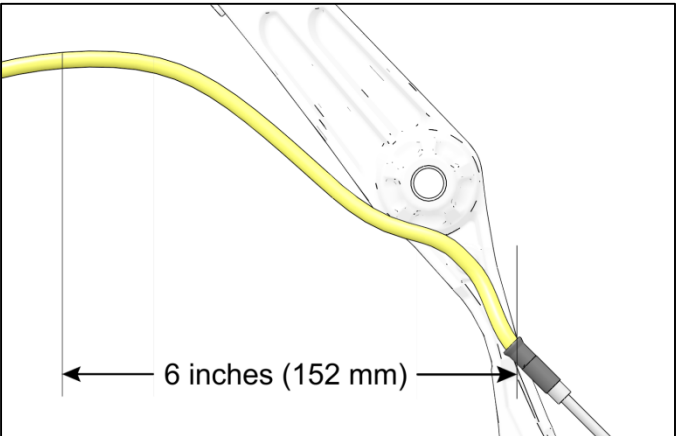

**MEASUREMENT**

Measure brake line rearward from Brake crimp location:  
**6 inches (152 mm)**

**NOTE**

If the brake line is damaged, refer to the online service manual for BRAKE LINE REPLACEMENT.

**POLARIS** Home Ask Polaris Enter Dealer Change Dealer POLARIS 532100 - COMPUTER-CONTROLLED Service and Warranty

STOP Site Links  
General Service Info  
MSD Training  
Service Bulletins  
Electronic Catalog  
Service Videos  
Flat Rate Manuals  
Set Up Instructions  
PDI Events  
Service Manuals  
Owner's Manuals  
STOP Home

Unit Inquiry  
Enter the VIN  
Go To Unit Inquiry

**Search Service Manuals by Model**

Product Line: Victory Year: 2017 Model Number: - All - Model Description: - All -

Search By Model Number  
Model Number: Search

Search By Model Description  
Model Description: Search

**Search Results**

Total number of Service Manuals found matching the above search criteria: 4

Product Line	Year	Model #	Model Desc.
Victory	2017	- All -	- All -
Models	Article#	Posted On	Article Subject
283 H	9927627_2017_35	9/22/2016	2012-17 Victory Cross Roads / Hard-Ball / Cross Country / Magnum
55 H	9927626_2017_36	8/9/2016	2012-17 Victory Vision
155 H	9927624_2017_VIC_Cou	9/8/2016	2013-2017 Victory Cruisers
17 H	9928924_2017_VIC_Oc	2/19/2016	2013-2014, 2016, 2017 2017 VIC Octane

Back STOP Home



## SWINGARM GUARD INSTALLATION

1. **NON-ABS MODELS ONLY:**

Remove brake line retainer ① on swingarm.

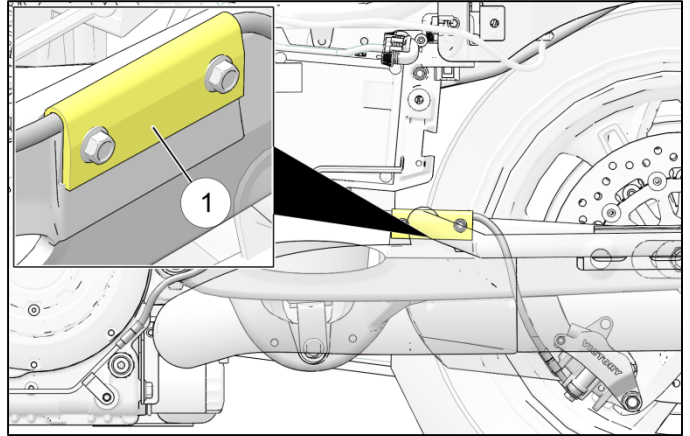

2. **ALL MODELS:**

Install the swingarm guard over the footrest bracket until fully seated.

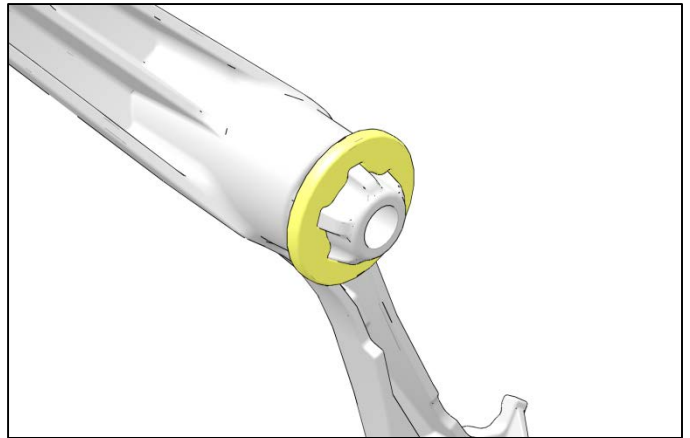

3. **ALL MODELS:**

**IMPROVED LINE ROUTING**

Route the brake line and oil pressure switch lines over the footrest as shown. Assemble the footrest over the swingarm pivot until fully seated.

*\*ABS model routing shown for illustration.*

**IMPORTANT**

Verify the brake line and oil pressure switch lines are not pinched between the footrest and swingarm pivot.

**NOTE**

**INTL MODELS:**

Sidestand Switch Wire will also route over the footrest.

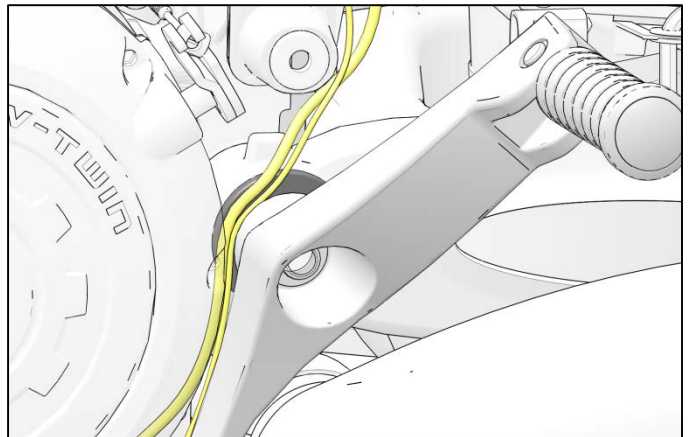



4. **ALL MODELS:**  
Verify the brake line tab is properly sandwiched between the bracket and footrest mounting boss.

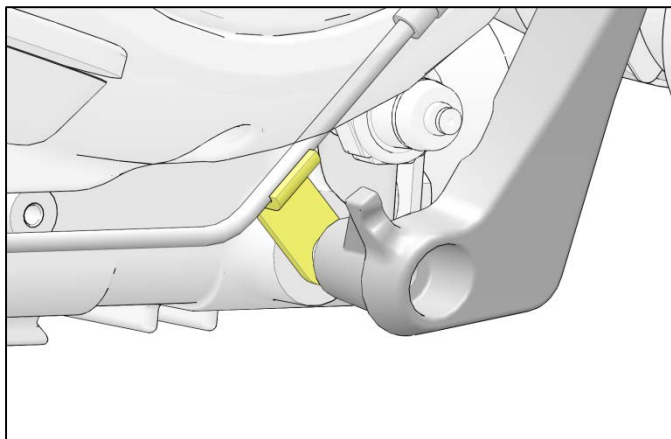

5. **ALL MODELS:**  
Install the lower footrest bolt (2) using a 6 mm allen and a torque wrench, Torque bolt to specification.

### **TORQUE**

Lower Footrest Bolt (2):  
**18 ft-lbs (24 Nm)**

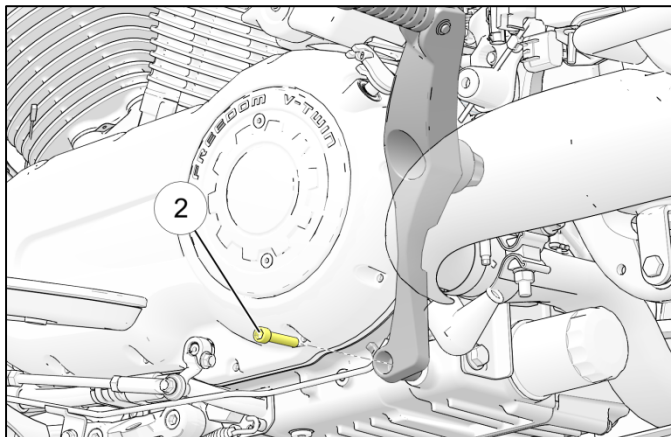

6. **ALL MODELS:**  
Install upper passenger footrest nut (3) and washer. Using a 15/16" socket and a torque wrench, torque nut to specification.

### **TORQUE**

Upper Footrest Nut (3):  
**65 ft-lbs (88 Nm)**

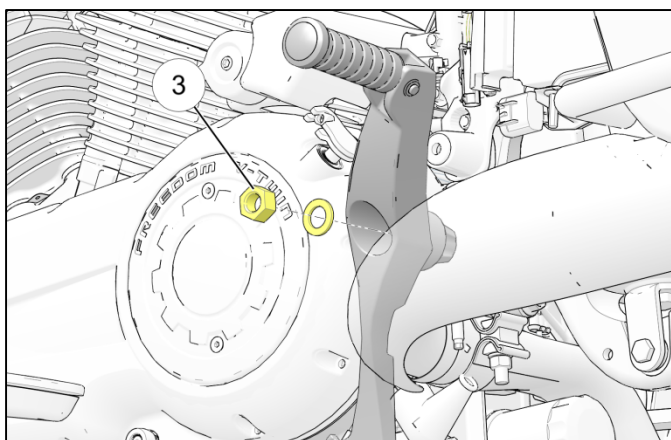

7. **ALL MODELS:**  
Connect oil pressure switch connector ④ in a vertical orientation as shown.

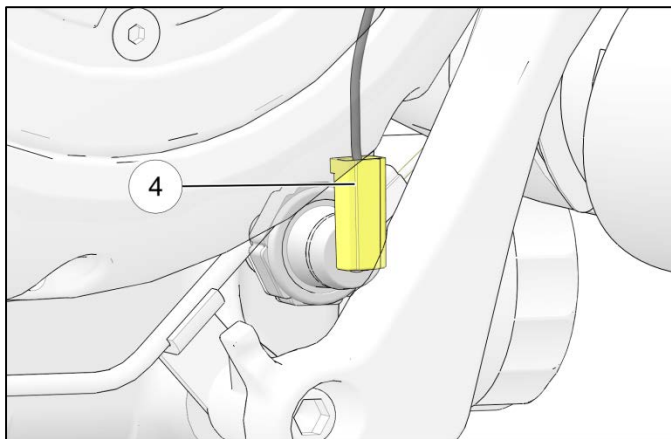

8. **NON-ABS MODELS ONLY:**  
Install brake line retainer P-Clamps ⑤.

**NOTE**

For **ABS models**, the supplied P-Clamps will not be used and should be disposed of properly.

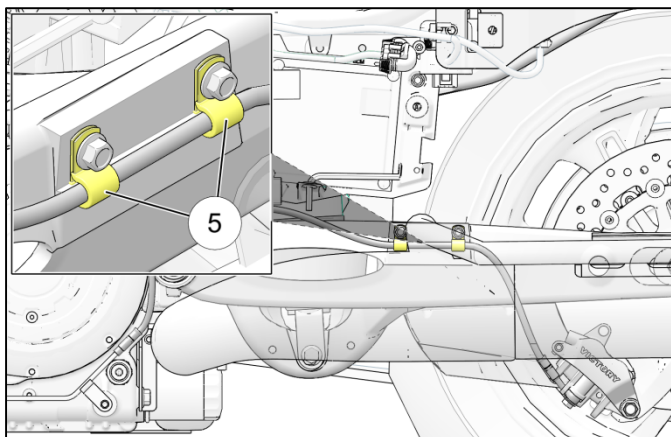

9. **ALL MODELS:**  
Install a completed Service Bulletin Completion Decal (7170107) on the inside of the side cover.

