

Door Trim Panel — Front  [Printable View \(316 KB\)](#)

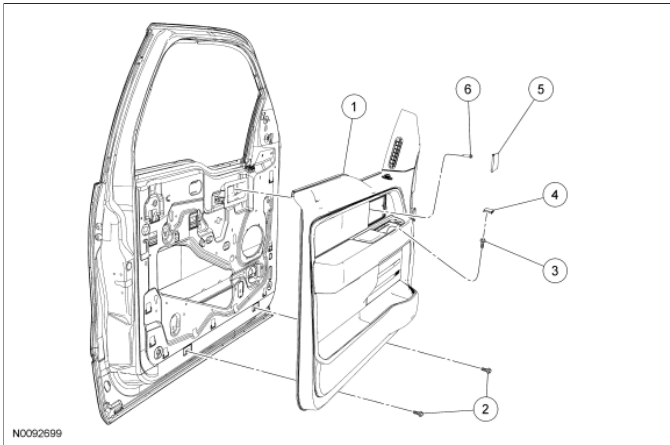

Item	Part Number	Description
1	23942	Front door trim panel
2	W701930	Front door trim panel lower screws
3	W701930	Front door pull cup screw
4	237W24	Front door pull cup screw cover
5	31458	Front door handle screw cover
6	W500215	Front door handle screw

Removal and Installation

NOTE: LH side shown, RH side similar.

1. If equipped, remove the window regulator handle.
 1. Separate the handle cover from the handle.
 2. Remove the screw.
 3. Remove the window regulator handle.
 4. Remove the spacer.

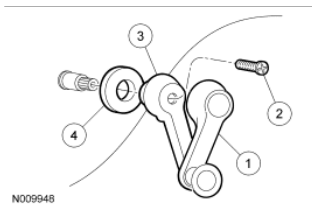

2. Remove the 2 front door trim panel lower screws.

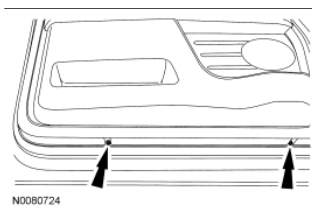

3. Remove the door handle cover plate.

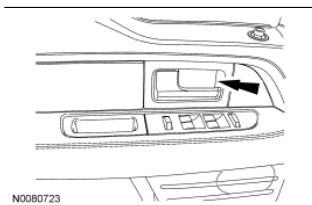

4. Remove the pull cup screw cover.

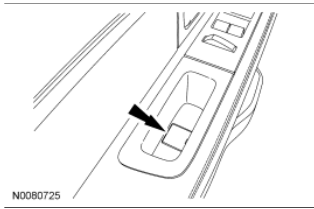

5. Remove the pull cup screw.

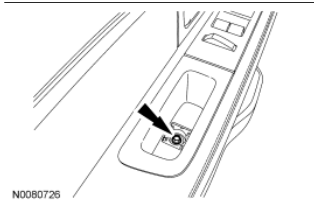

6. Remove the window control switch. For additional information, refer to [Section 501-11](#).
7. Remove the door handle screw.

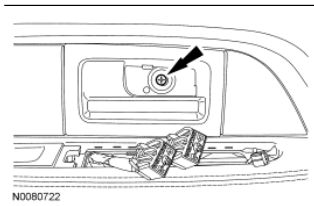

8. **NOTICE:** Do not pull directly outward on the front door trim panel, as damage may occur.

Remove the front door trim panel.

- Lift upward to remove the front door trim panel.
 - Disconnect mirror adjustment switch electrical connector.
 - Remove the front door handle.
 - Guide the door handle through the opening in the trim panel.
9. To install, reverse the removal procedure.
-